

1. Part List



Camera



Video / Power Extension

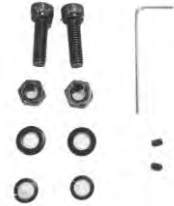

Hex Wrench / Spare Hex Bolts
License Plate Bolts and Nuts

2. Features & Specification

Bar-Type License Plate Camera with 3 Watt LEDs
Excellent Color Contrast
Excellent Low Light Performance
Reverse / Non-reverse Image Switch
Parking Guidelines On/Off Switch
Adjustable Vertical Camera Angle
Theft Deterrence License Plate Bolts and Nuts
Anti-Corrosive Long-Lasting Camera Body

1/4" Color CMOS Sensor
640(H) x 480(V) Effective Pixel Resolution
600TVL Resolution Details
170° Wide Viewing Angle
0.5Lux Min. Ill. w/o LED Lights
IP68 Waterproof
Zinc Metal Anti-Corrosive Camera Body

*U.S. DESIGN PATENT No. D734,804

3. Installation

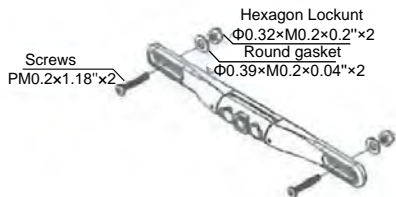

For theft deterrence, use the bolts and nuts to lock the license plate camera. Drilling holes for bolts may be required.

4. Vertical Camera Angle Adjustment

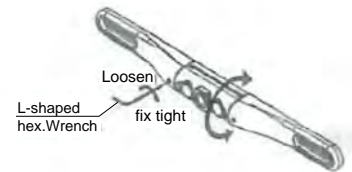

1. Loosen the camera: Use the provided hex wrench to loosen the screws on both sides of the camera.
2. Tilt camera to adjust the angle.
3. Tighten the screws to lock the camera angle.

5. Wiring

