

Snap Action Switches

Subminiature



S47

Features

- Actuator: Pin Plunger



NTE Type No.	Circuitry	Max. Pre-Travel	Min. Over Travel	Max. Operating Force	Max. Differential	Diag No.
54-418	SPDT	0.024"	0.016"	150g	0.005"	S47

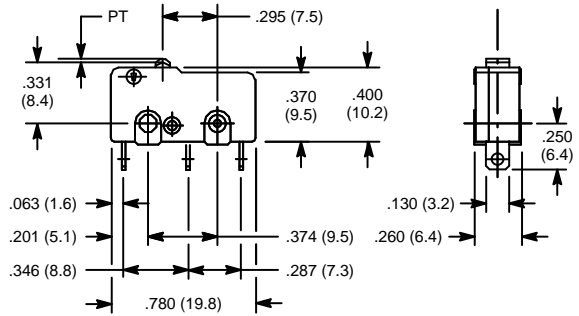

Specifications

Current Rating: 10.1A 125/250VAC, 0.4A 125VDC, 0.2A 250VDC
Contact Resistance: 30 Milliohms (max.) initial
Insulation Resistance: 100 Megohms at 500VDC
Dielectric Strength: 1000VAC (50/60Hz for 1 minute)
Temperature Rating: -13° to +185°F (-25° to +85°C) with no icing
Electrical Life: 50,000 cycles min. (under rated load)
Mechanical Life: 10,000,000 cycles min.
Terminal Type: Solder Terminals

General Purpose



S39

Features

- Actuator: Panel Mount Plunger



NTE Type No.	Circuitry	Max. Pre-Travel	Min. Over Travel	Max. Operating Force	Max. Differential	Diag No.
54-450	SPDT	0.05"	0.22"	625g	0.01"	S39

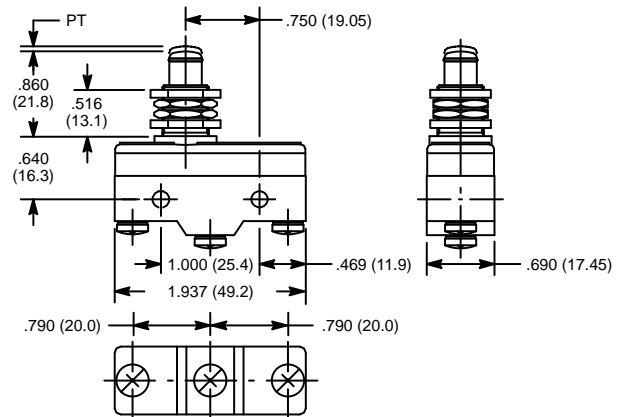

Specifications

Current Rating: 20A (12A) 125/250VAC
 0.5A 125/250VDC
Contact Resistance: 15 Milliohms (max.) initial
Insulation Resistance: 100 Megohms (min.) at 500VDC
Dielectric Strength: 1000VAC (50/60Hz for 1 minute)
Temperature Rating: -13° to +176°F (-25° to +80°C)
Electrical Life: 500,000 cycles min. (under rated load)
Mechanical Life: 1,000,000 cycles min.
Terminal Type: Screw Terminals