

## Introduction and Features

The RP4-NI13 interface allows the replacement of a factory radio in select Nissan vehicles with MSCAN databus radios. Using this interface will retain factory features, such as steering wheel controls (SWC), reverse camera, and the factory amplifier, when the original radio is removed. Use of this interface also allows you to program two radio functions to each SWC button by using short press, long press dual command functionality. The RP4-NI13 also provides outputs such as vehicle speed sensor (VSS), illumination and \*reverse trigger.

## Important Notes

1. These instructions apply to R.1.5.1.4 or later revisions. The revision info can be found on a small white sticker on the interface and packaging.
2. The radio select rotary switch on the side of the interface, must be adjusted to the proper radio setting before plugging the interface into the vehicle (see next page for setting chart).
3. The interface comes pre-programmed for all of the vehicle's factory SWC functions, and does not require programming unless you wish to re-assign the SWC functions, or utilize short press, long press dual command functionality. The SWC can always be restored to default settings by pressing and releasing the program button on the side of the interface once, and waiting 7 seconds for the LED to flash 4 times.
4. Does not retain 360 camera system.

## Wiring Connection Chart

### Vehicle Connector

Yellow	Battery +12v
Black	Ground
Red	Accessory 12v+ (10 amp)
Pink	Vehicle Speed Output
Blue / White	Amp Turn On Input
Orange / White	Illumination Output (+)
Purple / White	*Reverse Output (+)

White	Front L + input
White / Black	Front L - input
Gray	Front R + input
Gray / Black	Front R - input
Green	Rear L + input
Green / Black	Rear L - input
Purple	Rear R + input
Purple / Black	Rear R - input
Yellow RCA	*Reverse Camera Output

### SWC Connector

Blu/Yel	Kenwood, Newer JVC
3.5mm Jack	Alpine, JVC, Clarion, Fusion, Pioneer, Sony, Boyo, Dual, Lightning Audio, Visteon or Advent

\* Only available in vehicles equipped with a factory reverse camera.

## Illustration / Schematic

### Wiring

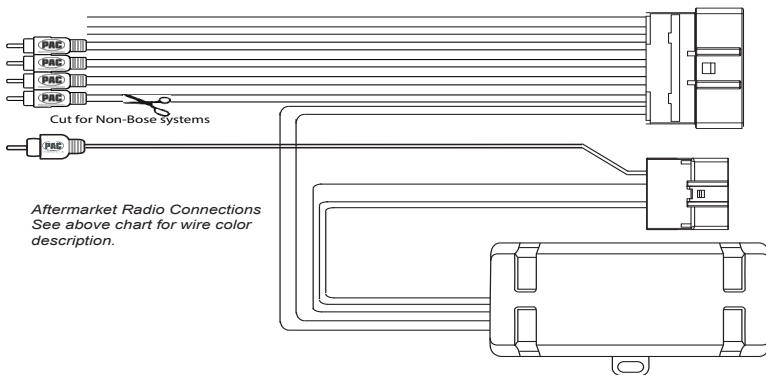

### SWC Connection

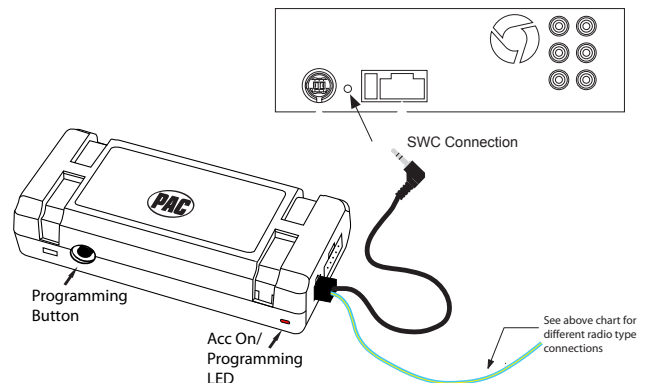

## Installation Steps



### SET RADIO SELECT SWITCH

Alpine	JVC	Kenwood / Lightning Audio	Clarion / Nakamichi	Pioneer / Other*	Sony	Fusion
1	2	3	4	7	8	9

\*Other - Dual / Axxera, Jensen, Rockford Fosgate

## Default Steering Wheel Control Programming

**IMPORTANT!** The interface comes pre-programmed for all of the vehicle's factory SWC functions and does not require programming, unless you wish to re-assign the SWC functions, or utilize short press, long press dual command functionality. The SWC can always be restored to default settings by pressing and releasing the program button on the side of the interface once, and waiting 7 seconds for the LED to flash 4 times.

### Default SWC Button Assignments

	Alpine	JVC	Kenwood	Clarion	Pioneer	Sony	Fusion
Volume +	Volume +	Volume +	Volume +	Volume +	Volume +	Volume +	Volume +
Volume -	Volume -	Volume -	Volume -	Volume -	Volume -	Volume -	Volume -
Source	Source	Source	Source	Source	Source	Source	Source
Track +	Track +	Track +	Track +	Search +	Track +	Track +	Track +
Track -	Track -	Track -	Track -	Search -	Track -	Track -	Track -
Enter	Voice	Voice	Voice	Voice	Voice	Voice	Power
Phone Answer	Receive	Receive	Off Hook	Send	Answer Call	Answer/End	Audio
Phone End	End	Reject	On Hook	End	End	Reject/Source	Mute

## Optional Steering Wheel Control Programming

If you wish to re-assign the SWC functions, or utilize short press, long press dual command functionality, the interface must be programmed in the specific order shown on the chart below. If you come across a function in the chart that your steering wheel does not have, or you do not want to program, press and release the program button on the side of the interface to skip that function. The LED will flash off and on, confirming that you have successfully skipped that function and are ready to proceed to the next one.

- Turn the key to the ignition position.
- Press and release programming button on the side of the interface.
- Within 7 seconds, press the button that is to be learned on the steering wheel. The LED will turn off when the button is pressed.
 

**At this point you have two options:**

  - For short press functionality:** Release the button within 1.5 seconds. The LED will turn back on.
  - For long press functionality:** Hold the button until the LED starts blinking. Release the button and the LED will go back to solid.
- If you need to program more buttons, repeat step 3 for each additional audio function on the steering wheel.
- If you come across a function in the chart that your steering wheel does not have, or you do not want to program, press and release the program button on the side of the interface to skip that function.
- Once programming is completed, wait seven seconds. The LED will flash three times, indicating end of programming.
- Test the interface for proper functionality. Whenever a SWC is pressed, the LED on the interface should blink. If any function does not work, repeat the programming steps.

## Optional Programming Order

	Alpine	JVC	Kenwood	Clarion	Other *	Pioneer	Sony	Fusion
1	Volume +	Volume +	Volume +	Volume +	Volume +	Volume +	Volume +	Volume +
2	Volume -	Volume -	Volume -	Volume -	Volume -	Volume -	Volume -	Volume -
3	Mute	Mute	ATT	Mute	Mute	Mute	Mute	Mute
4	Preset +	Source	Source	Source	Preset +	Preset +	Preset +	Source
5	Preset -	Track +	Play	Search +	Preset -	Preset -	Preset -	Track +
6	Source	Track -	Track +	Search -	Source	Source	Source / End Call	Track -
7	Track +	Band / Disc +	Track -	Band	Track +	Track +	Track +	Audio
8	Track -	Preset / Disc -	Disc / FM +	Send / End	Track -	Track -	Track -	Power
9	Power	Select	Disc / AM -	Send	Band	Band	Band	
10	Enter / Play	Attenuation	Answer	End	Answer **	Phone Menu	Power / End Call	
11	Band / Program	Phone Receive	Voice	Voice	End **	Answer Call	Voice / Answer / End Call	
12	Receive	Phone Reject	On Hook		PTT **	End Call	Voice(Android Auto & Car Play) Answer / End Call ***	
13	End	Voice	Off Hook			Voice		
14	Voice	Power	Mute					
15			Preset +					

\* Advent, Boyo, Dual, Lightning Audio, Jensen, Rockford Fosgate & Visteon    \*\* Jensen & Advent ONLY    \*\*\* XAV-AX100 ONLY

## Testing and Verification

1. Turn the ignition on. The LED on the interface will turn on, and the +12v accessory wire will turn on.
2. Turn on the radio and check balance and fade.
3. Verify that all SWC are functioning properly.
4. The LED and radio will turn off when the key is turned off.

## Product Updates (Firmware)

The RP4-NI11 can be updated with new firmware as it becomes available, using the PAC-UP interface updater (sold separately). Please visit [www.pac-audio.com/firmware](http://www.pac-audio.com/firmware) for available updates.

